

**180 litre manual defrost vertical freezer with 5 plastic freezer baskets and ice cube storage bin.  
Combine it with a 240L all fridge (WRM2400WD) to give you a 420L pigeon pair.**

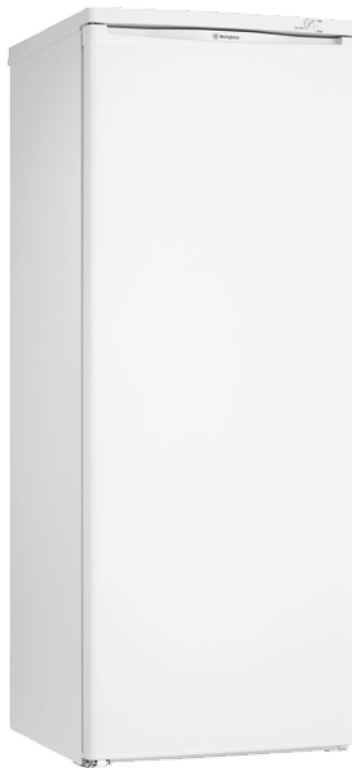

## Product Details

### FEATURES

---

5 x full- width freezer baskets	Reversible door	R600a refrigerant better for the environment	Pigeon Pair with WRM2400WC
---------------------------------	-----------------	---	-------------------------------

---

Ice cube storage bin

---

### BENEFITS

---

R600a refrigerant More environmentally friendly	Reversible door The door is reversible so that it may be positioned as either left or right hand side opening
--	---

---

5 x full- width freezer baskets Organised storage solution.	Pigeon Pair with WRM2400WD Pigeon Pair 180L freezer (WFM1800WD) combined with 240L refrigerator (WRM2400WD) providing a total of 420L of storage
--	--

---

## Specifications

### PRODUCT PROFILE

Domestic warranty details (yrs)	2
Additional domestic warranty for the sealed refrigeration system only (yrs)	3
Refrigerator Type	vertical freezer
Exterior door finish	White
Fridge door opening	reversible
Cooling system	cyclic
Refrigerant	R600a

### ENERGY

Energy Star Rating AS/NZS 4474.2:2009	3
Energy consumption AS/NZS 4474.2:2009 (kWhr/yr)	274

### DIMENSIONS

Total height (mm)	1453
Cabinet height (mm)	1393
Total width (mm)	550
Cabinet width (mm)	550
Total depth (mm)	555
Cabinet depth (mm)	490
Depth door open 90degree (mm)	1077
Freezer compartment capacity (gross in litres)	180
Total Gross Capacity (L)	180

### REFRIGERATOR SYSTEM

Controls	manual
Controls location	internal

FREEZER COMPARTMENT

ICE FACILITY

Ice cube tray	1
Ice cube storage bin	1

BASKET/DRAWER

Full width wire basket with fascia	5
------------------------------------	---

## Dimensions

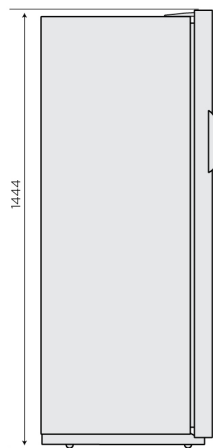
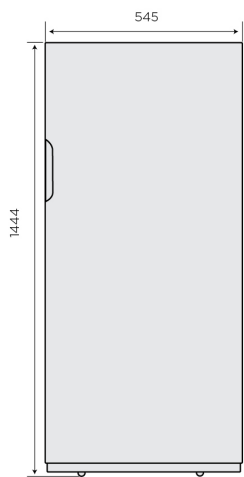

### Recommended minimum clearances

**Please note:** Doors are designed to sit proud of cabinetry (not flush).

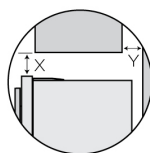

If you have a cupboard above the refrigerator with a rear gap of less than 100mm (Y), recommended minimum clearance at the top of the refrigerator increases from 30mm to 70mm (X).

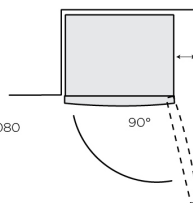
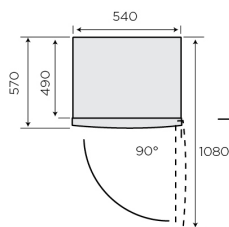
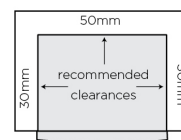

When positioned in a corner area, clearance of at least 350mm on the hinge side will allow the doors to open enough to enable the removal of the bins and shelves.

## Terms and Conditions

### IMPORTANT

This is a guide of product dimensions only. For complete installation instructions, refer to the manual provided with product.

### PRODUCT INFORMATION

The descriptors and illustrations in this publication apply to the specific products and models described as at the date of issue. Under our policy of continuous product development, product specifications may change without notice. Prospective purchasers should therefore check with their retailer to ensure this publication correctly describes the products that are being offered for sale. All information supplied is to be used for general reference purposes only and is on the understanding that Electrolux Home Products Pty Ltd (Australia) and Electrolux (NZ) Ltd (New Zealand) will not be liable for any loss, liability or damage of whatever kind arising as a result of reliance on such information. Colours of products illustrated are as close as printing limitations allow. Electrolux will at all times comply with its obligations pursuant to law including Trade Practices (Australian Consumer Law) Act and Regulations.

### WARRANTY

This warranty only applies to Appliances purchased and used in Australia or New Zealand and used in normal domestic applications and is in addition to (and does not exclude, restrict, or modify in any way) any non-excludable statutory warranties in Australia or New Zealand. All warranties are subject to the conditions set out in the warranty card accompanying the product when purchased.

#### ELECTROLUX HOME PRODUCTS AUSTRALIA

telephone: 1300 363 640

fax: 1800 350 067

email: [customercare@electrolux.com.au](mailto:customercare@electrolux.com.au)

web: [www.electrolux.com.au](http://www.electrolux.com.au)

#### ELECTROLUX HOME PRODUCTS NEW ZEALAND

telephone: 09 573 2230

fax: 09 573 2221

email: [customercare@electrolux.co.nz](mailto:customercare@electrolux.co.nz)

web: [www.electrolux.co.nz](http://www.electrolux.co.nz)