

Clothes Dryer

Model: WDV5051



Westinghouse



Thank you for buying a  
Westinghouse Fully Automatic Clothes Dryer.  
Please read your owner's manual carefully,  
it provides instructions on use and maintenance.  
Retain it for future reference.  
Record the model and serial number of your clothes dryer.

# Contents

Important Safety Instructions			
Dryer Safety	page 3	Useful Hints	page 7
Fire Hazards	page 3	Useful Hints (continued)	page 8
Cleaning the lint filter	page 4	Troubleshooting	page 8
Drying Guide	page 4	Accessories	page 8
Installation Instructions	page 5	Warranty	page 9
Quick 5 Step Startup Guide	page 6	Key Feature Guide	page 10
Quick 5 Step Startup Guide (continued)	page 7	Purchase Details	page 11

## Important Safety Instructions

### DRYER SAFETY

Failure to follow these safety instructions could damage the dryer or your clothes.

**You may then not be covered by warranty for this damage.**

Only plug this appliance directly into an AC power supply, which is properly earthed and has the correct voltage. See the serial number sticker located on the top of the door opening for voltage information.



**CAUTION:** If this appliance is supplied from a cord extension set or electrical portable outlet device, the cord extension set or electrical portable outlet device must be positioned so that it is not subject to splashing or ingress of moisture. For safety reasons we strongly advise against the use of double adaptors, extension cords or power boards.

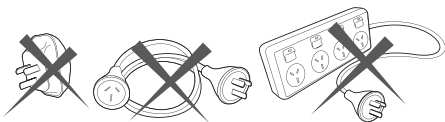

This appliance is not intended for use by persons (including children) with reduced physical, sensory or mental capabilities, or lack of experience and knowledge, unless they have been given supervision or instruction concerning use of the appliance by a person responsible for their safety. Children should be supervised to ensure that they do not play with the appliance.

#### IMPORTANT:

- **If the electrical cord of this appliance is damaged, it must be replaced by the Manufacturer, Authorised Service Agent or similarly qualified person in order to avoid a hazard.**
- **These dryers are for drying clothes, towels and linen at home. Do not use them for any other purpose.**
- **Lint must not be allowed to accumulate around the tumble dryer.**
- **Do not dry unwashed items in the tumble dryer.**

**WARNING: Never stop a tumble dryer before the end of the drying cycle unless all items are quickly removed and spread out so that the heat is dissipated.**

### FIRE HAZARDS

Some fabrics are not suitable for tumble drying. The following **MUST NOT** be placed in your dryer due to the risk of a fire or an explosion:

- Items that have been spotted or soaked with **vegetable oil, cooking oil, suntan oil, linseed oil, salad oil, lubrication oil or grease**. Oil affected items can ignite spontaneously, especially when exposed to heat sources such as in a tumble dryer. The items become warm, causing an oxidation reaction in the oil. Oxidation creates heat. If heat cannot escape, the items can become hot enough to ignite. Piling, stacking, or storing oil-affected items can prevent heat from escaping and create a fire hazard. If it is unavoidable that fabrics that contain vegetable or cooking oil, or have been contaminated by hair care products be placed in a tumble dryer, they should first be washed in hot water with extra detergent - this will reduce, but not eliminate, the hazard. The 'cool down' cycle of tumble dryers should be used to reduce the temperature of the items. They should not be removed from the tumble dryer or piled while hot.
- Items that have previously been cleaned in, washed in, or spotted with **petrol/gasoline, industrial chemicals used only for cleaning, dry-cleaning solvents or other flammable or explosive substances**. Highly flammable substances commonly found around the house include acetone, (nail polish remover) denatured alcohol, petrol/gasoline, kerosene, some spot removers, turpentine, waxes and wax removers. Items containing foam rubber (also known as latex foam) or similarly textured rubber-like materials. Foam rubber materials can produce fire by spontaneous combustion when heated.
- Rubber-backed articles, clothes fitted with foam rubber pads, pillows, rubber boots and rubber-coated sports shoes.

For your safety, and to reduce the risk of fire or an explosion, **DO NOT** store or use petrol or other inflammable vapours and liquids near your dryer.

# Important Safety Instructions

## CLEANING THE LINT FILTER

### LINT BUILD-UP IS A FIRE HAZARD

A clean lint filter reduces drying times, saves energy and avoids overheating. Overheating may also damage your clothes.

What happens if I forget to clean the lint filter?

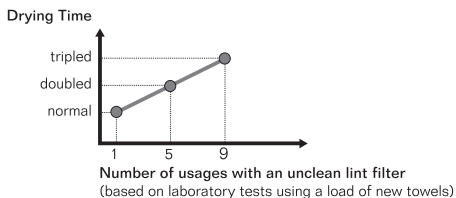

The lint filter is located at the front of your dryer at the bottom of the door opening.



You must clean this lint filter after every load.

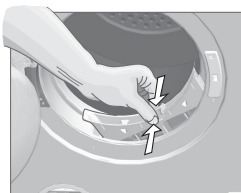

To remove the lint filter open the door and press the two pads together. Pull the lint filter out of the pocket.

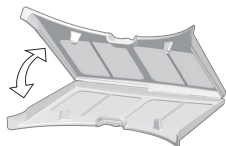

Open apart the lint filter and wipe or peel off the lint.

Ensure the lint filter 'clicks' when replacing. It can be inserted into the pocket either way.

- Never operate your dryer without the lint filter.
- Do not allow lint to build around your dryer.
- A torn or damaged lint filter must be replaced immediately.
- Overloading can increase lint build-up because the airflow is reduced.

To avoid potential fire hazards, we recommend that you pay a qualified service technician to periodically clean your dryer. You must do this also when you change your mounting from upright to inverted, or vice versa.

## DRYING GUIDE

Your load, when dry must not exceed the rated capacity.

- 5kg

(See page 8 for a table of average weights of laundry items)

Always check your labels for the drying symbols which the International Care Labelling Code now uses.



May be tumble dried



Normal drying (high temperature)



Do Not Tumble Dry



Delicate drying (low temperature)

- **Permanent press and synthetics** - take out as soon as the dryer stops to reduce wrinkles.
- **Woollen articles** - not recommended. Pull them to their original shape, then dry them flat.
- **Woven and loop knit materials** - may shrink, by varying amounts, depending on their quality. Do not use the 'normal' setting for these fabrics. Always stretch them out immediately after drying.
- **Fibre or leather materials** - always check the manufacturer's instructions.
- **Baby clothes and night gowns** - acrylic clothing or sleepwear use only on the 'delicates' setting.
- **Rubber and plastics** - Do not dry any items made from or containing rubber or plastics, such as aprons, bibs, babies' waterproof napkins, curtains, tablecloths, shower caps, clothes fitted with foam rubber pads, pillows, galoshes, or rubber coated tennis shoes.
- **Fibreglass** - not recommended. Glass particles left in the dryer could be picked up by your clothes the next time you use the dryer, and irritate your skin.

Fabric softeners or similar products should not be used in a tumble dryer to eliminate the effects of static electricity unless this practice is specifically recommended by the manufacturer of the fabric softener or product.

**Note: We strongly advise against the use of fabric conditioners of the sheet type that are added to the clothes in the drum. These products may lead to rapid blockage of the lint filter and inefficient operation of your dryer.**



# Installation Instructions

You can choose to put your dryer:-

- on the floor.
- on a work bench.
- on a wall, upside down or upright, using the included mounting kit.
- on top of a front load washing machine (using a stacking kit available as an optional extra).

The appliance must not be installed behind a lockable door, a sliding door or a door with a hinge on the opposite side to that of the tumble dryer in such a way that a full opening of the tumble dryer door is restricted.

## Stacking Kit

You can use a stacking kit if you want to mount your dryer on top of a front load washing machine. Use kit part number DKSK03. Refer to the kit instructions on how to install.

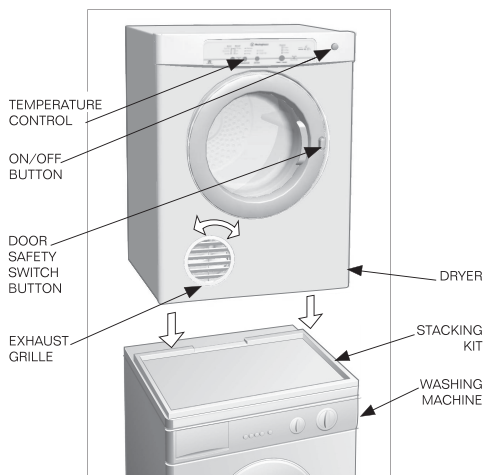

The exhaust grille has a range of positions, which allows you to select the optimum exhaust air angle. Simply hold the grille and rotate it until it hits the built-in stop.

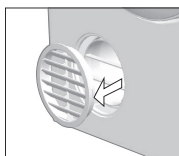

removable exhaust grille

**Do not install your dryer in a cupboard or small un-vented laundry unless you are using a venting kit.**

There are 2 VENTING OPTIONS

- front
- rear-using a included kit

**Important:** Use only kits approved by Electrolux with your dryer.

The exhaust duct must not exceed 2 metres in length at 100mm diameter.

If connecting the dryer to a common ducting system, safety advice should be requested from the manufacturer.

If you choose to use included kit, the exhaust grille at the front of the dryer will need to be replaced with the outlet cover from the back of the dryer. Gently prise open the grille, using a thin bladed tool. Next, remove the cover from the back and clip it into the grille space at the front. The exhaust grille is not required when using a vent kit.

**Do not install your dryer in a cupboard or small unventilated room.**

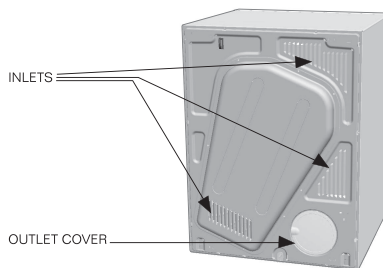

You can position the vent kit at the back of the dryer to remove air upwards or sideways.

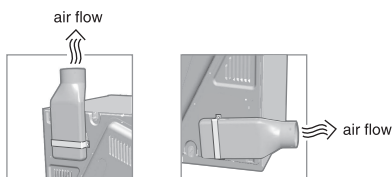

Inlet and outlet points need clear airflow to prevent overheating, so ensure there is adequate ventilation. (i.e. open window or external door.)

If a venting kit is used and the exhaust is discharged out of the room, there must be adequate ventilation to avoid the back flow of gases in to the room from appliances burning other fuels, including open fires, when operating the tumble dryer. This is not applicable where a venting hose is directed to an open window. The exhaust air must not be discharged into a flue which is used for exhausting fumes from appliances burning gas or other fuels.

# Quick 5 Step Start Up Guide

- 1 Load your dryer loosely until it is no more than **TWO THIRDS FULL**. Clothes must tumble freely in a dryer. Don't cram them in. Wet clothes fluff up when dry.

## Overloading will:

- Reduce efficiency
- Increase drying time
- Increase the risk of creasing

Do not load clothes or other articles which are dripping wet into your dryer.

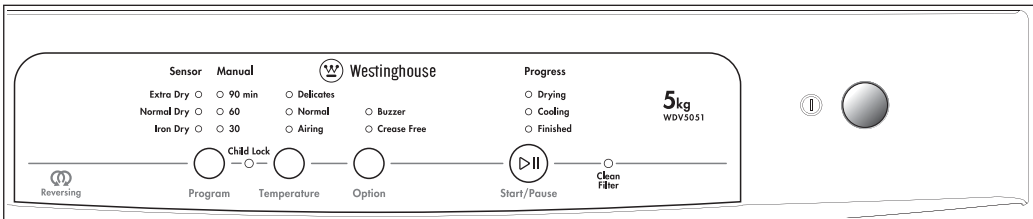

- 2 Press then release the on/off  button on the sensor control panel. (See below) You are now ready to select your drying Program.

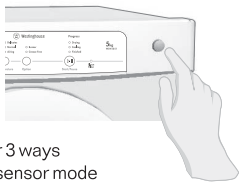

You can use your dryer 3 ways

1. Pre selected sensor mode
2. Personally selected sensor mode
3. Manual timer mode

### 1. Using Pre selected sensor mode

To operate your dryer in this mode you only have to push the **START/PAUSE** pad. The dryer will start and dry the load at full heat to the **Normal dry** dryness level.

Near the end of the cycle the heater will turn off and the dryer will be operating in the cool down mode.

### 2. Using Personally selected sensor mode

The mode give the option of selecting a number of features from the **Sensor PROGRAM** that you can choose.

1. Press the **PROGRAM** pad to select either **Extra dry**, **Normal dry** or **Iron dry** from the **Sensor PROGRAM**. Do not select the **Extra dry** option for delicates such as polyester as shrinking may occur.
2. Press the **TEMPERATURE** pad to select either **Normal** or **Delicates** from the **TEMPERATURE** program. **Airing** is not available in Sensor mode. The indicator light will come on to your choice.

Now press the **START/PAUSE** pad to start the dryer.

### 3. Using Manual timer mode

Using this mode gives the option of selecting a number of features from the **Manual PROGRAM** and **TEMPERATURE** that you can choose.

1. Press the **PROGRAM** pad to select either **90**, **60** or **30** Minutes from the **Manual PROGRAM**. The indicator light comes on for your selection.
2. Press the **TEMPERATURE** pad to select either **Normal**, **Delicates** or **Airing**. The indicator light comes on for your selection.

Now press the **START/PAUSE** pad to start the dryer.

### Options

The end of cycle **Buzzer**, and **Crease Free** can be selected using the **OPTION** pad. If the **OPTION** pad has not been pressed the **Buzzer** is selected automatically. Pressing once will de-select the **Buzzer** and select **Crease Free**, another press will select both options, and another press will de-select both options.

The **Crease Free** feature is designed to help prevent creases forming in the clothes after the normal drying cycle has finished. The drum will rotate for 5 seconds every minute and will go for 3 hours. This is useful if you are unable to empty the dryer straight away.

### Child Lock

With all three modes you can use **Child Lock**.

While the dryer is running press the **PROGRAM** and **TEMPERATURE** pads at the same time for at least 2 seconds. The buzzer will sound and the **Child Lock** light will come on. To remove the **Child Lock** follow the same procedure. When the **Child Lock** is selected all pads (except On/Off button) will not operate. If you open and close the door during operation the **Child Lock** will have to be reset.

# Quick 5 Step Start Up Guide (continued)

## 3 Switch On

The dryer will not operate unless the button on the door is fully pressed in.

DOOR  
SAFETY  
SWITCH  
BUTTON

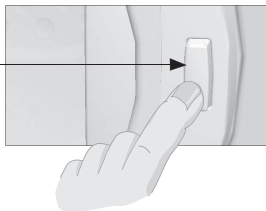

## 4 Switch Off

When you have finished using the dryer, press the On/Off **⓪** button, to turn off the power, then switch off at the power point. It is not recommended that the power be left on to the dryer.

## 5 Clean Lint Filter

After every load clean the lint filter to reduce drying times and avoid overheating.

## Checking the load

To check the dryness or add clothes during the cycle, simply open the door. The dryer will beep several times indicating the door is open. If further drying is required, close the door and push in the door safety switch button, then press the **START/PAUSE** pad to continue.

**For the best drying performance, only add or remove clothes near the beginning of the drying cycle.**

## Cooling

Your dryer will automatically switch off the heater at the end of every drying cycle. The cooling light will come on. This is important as it removes stored heat from the clothes and helps prevent creasing.

At the end of cooling the buzzer will sound to indicate your clothes are dry (unless you have de-selected this function). It will sound again after fifteen minutes. The Clean the filter Reminder light will remain on.

The progress indicator lights let you know what the dryer is doing, either drying, cooling or finished.

## Useful Hints

- Never tumble dry the following: Delicate items such as net curtains, woollen, silk, fabric with metal trim, nylon tights, bulky materials such as anoraks, blankets, eiderdown, sleeping bags, feather quilts and any item containing rubber foam or materials similar to foam rubber.
- Do not place in your dryer undergarments such as bras and corsets that contain metal reinforcements. Your dryer may be damaged if metal parts were to come loose from the garment. Place such items in a bag designed for this purpose.
- For nylon socks and other small light items, place them in a bag designed for this purpose. This will stop these items being caught in the lint filter cavity.
- Check and empty pockets. Clips, pens, nails and pins can damage both the dryer and your clothes. Other items such as matches or cigarette lighters will cause a fire.
- Close all press studs, hooks, eyes and zips that may catch on something else. Tie all belts and apron strings to prevent tangling.
- Drying time will depend on fabric type and construction, load size and wetness. Save time and money and always spin the load as dry as possible in your washing machine.

- The time will also be affected by voltage fluctuations, room temperature and humidity. Clothes will dry more slowly on a cool or humid day.
- For best results, sort the load according to fabric types. Such as heavy items which may take longer to dry, eg towels, flannelette sheets etc, than ones which dry quickly, eg poly/cotton shirts and sheets.
- Avoid drying dark clothes with light coloured items such as towels as lint will show on the dark clothes.

**Note: Some fabrics will collect lint from other clothes and items. Separate the lint 'givers' and the lint 'collectors' to minimise this problem.**

Clothes that give lint include towels, nappies, chenille. Clothes that collect lint include corduroy, synthetics and permanent press garments.

- If individual items are still damp after drying, set a 30 minute post drying time. This will be necessary particularly for multilayered items (eg collars, pockets, etc).
- Always clean the lint filter - this will reduce drying time and save you money.

## Reversing Action

The drum is designed to turn in each direction, clockwise and anti-clockwise. This reduces tangling and gives more even drying in a shorter time.

# Useful Hints, Troubleshooting & Accessories

## USEFUL HINTS (continued)

- The laundry must be thoroughly spun before tumble drying.
- Easy-care items eg shirts, should be briefly pre-spun before drying (depending on the crease resistance approximately 30 seconds)
- To avoid static charge when drying is completed, use either a fabric softener when you are washing the laundry or a fabric conditioner specifically for tumble dryers.
- Remove the laundry when the dryer has finished drying.
- Do not over-dry laundry, this avoids creasing and saves energy.
- Clothes or towels containing sand or grit should be washed first.

To help you, here is a list of the average weights of some common laundry items.

Sheet	700 - 1000g
Tablecloth	400 - 500g
Kitchen towel	70 - 120g
Table napkin	50 - 100g
Towelling hand towel	150 - 250g
Bathrobe	1000 - 1500g
Men's shirt	200 - 300g
Pillowcase	100 - 200g
Men's pyjamas	400 - 500g
Ladies nightdress	200 - 250g
Bath towel	300 - 400g

## TROUBLESHOOTING

Check the points listed here **before** you call for help, and **make sure that you have followed the Dryer Safety on pages 3 & 4.**

**If you can't start your dryer, check these probable causes.**

- Plug is not firmly in socket, or power not turned on.
- You have blown a fuse. Check that power point with another appliance.
- You have not closed the dryer door or pushed in the door safety switch button.

**If your clothes are still wet:**

- The selected drying time was insufficient. Select a longer time setting.
- Longer time may be needed when the room temperature is 10°C or less.
- Check that the lint filter is not blocked.
- Check to see that you have read all the instructions carefully.
- Contact the Service Centre if you are still having problems. Write down the model and serial numbers and the date of purchase before you ring. The Service Centre will need this information.

### Important

To operate efficiently the clothes dryer must have an unrestricted air supply and exhaust ventilation.

**Service calls resulting from installation where ventilation is restricted are not covered by warranty.**

**THE COST OF THIS TYPE OF CALL WILL BE CHARGED TO THE CUSTOMER.**

Should you require further instructions in the use and care of your clothes dryer please contact the CUSTOMER CARE CENTRE on the phone numbers listed:

Australia.... **1300 363 640** **8am to 7pm EST & 8pm EDST**  
Monday to Friday

New Zealand... **(09) 573 2384** **8am to 5pm**  
Monday to Friday

If you have a warranty or spare parts enquiry you should call the number listed on page 9.

## ACCESSORIES

You can buy both the venting kits and the stacking kit (as mentioned on page 5) from your local appliance shop or Electrolux Home Products Pty. Ltd. Spare Parts Distributor.



# Electrolux Warranty

FOR SALES IN AUSTRALIA AND NEW ZEALAND  
APPLIANCE: ELECTROLUX DRYER

**This document sets out the terms and conditions of the product warranties for Electrolux Appliances. It is an important document. Please keep it with your proof of purchase documents in a safe place for future reference should you require service for your Appliance.**



1. In this warranty:
  - (a) 'acceptable quality' as referred to in clause 10 of this warranty has the same meaning referred to in the ACL;
  - (b) 'ACL' means Schedule 2 to the Competition and Consumer Act 2010;
  - (c) 'Appliance' means any Electrolux product purchased by you and accompanied by this document;
  - (d) 'ASC' means Electrolux authorised service centres;
  - (e) 'Electrolux' means Electrolux Home Products Pty Ltd of 163 O'Riordan Street, Mascot NSW 2020, ABN 51 004 762 341 in respect of Appliances purchased in Australia and Electrolux (NZ) Limited (collectively 'Electrolux') of 3-5 Niall Burgess Road, Mount Wellington, in respect of Appliances purchased in New Zealand;
  - (f) 'major failure' as referred to in clause 10 of this warranty has the same meaning referred to in the ACL and includes a situation when an Appliance cannot be repaired or it is uneconomic for Electrolux, at its discretion, to repair an Appliance during the Warranty Period;
  - (g) 'Warranty Period' means the Appliance is warranted against manufacturing defects in Australia for 24 months and in New Zealand for 24 months, following the date of original purchase of the Appliance;
  - (h) 'you' means the purchaser of the Appliance not having purchased the Appliance for re-sale, and 'your' has a corresponding meaning.
2. This warranty only applies to Appliances purchased and used in Australia or New Zealand and used in normal domestic applications and is in addition to (and does not exclude, restrict, or modify in any way) any non-excludable statutory warranties in Australia or New Zealand.
3. During the Warranty Period Electrolux or its ASC will, at no extra charge if your Appliance is readily accessible for service, without special equipment and subject to these terms and conditions, repair or replace any parts which it considers to be defective. Electrolux or its ASC may use remanufactured parts to repair your Appliance. You agree that any replaced Appliances or parts become the property of Electrolux. This warranty does not apply to light globes, batteries, filters or similar perishable parts.
4. Parts and Appliances not supplied by Electrolux are not covered by this warranty.
5. To the extent permitted by law, you will bear the cost of transportation, travel and delivery of the Appliance to and from Electrolux or its ASC. If you reside outside of the service area, you will bear the cost of:
  - (a) travel of an authorised representative;
  - (b) transportation and delivery of the Appliance to and from Electrolux or its ASC.

In all instances, where the Appliance is transported by Electrolux or an Electrolux authorised representative, the Appliance is transported at the owner's cost and risk while in transit to and from Electrolux or its ASC.
6. Proof of purchase is required before you can make a claim under this warranty.

7. You may not make a claim under this warranty unless the defect claimed is due to faulty or defective parts or workmanship. Electrolux is not liable in the following situations (which are not exhaustive):
  - (a) the Appliance is damaged by:
    - (i) accident
    - (ii) misuse or abuse, including failure to properly maintain or service
    - (iii) normal wear and tear
    - (iv) power surges, electrical storm damage or incorrect power supply
    - (v) incomplete or improper installation
    - (vi) incorrect, improper or inappropriate operation
    - (vii) insect or vermin infestation
    - (viii) failure to comply with any additional instructions supplied with the Appliance;
  - (b) the Appliance is modified without authority from Electrolux in writing;
  - (c) the Appliance's serial number or warranty seal has been removed or defaced;
  - (d) the Appliance was serviced or repaired by anyone other than Electrolux, an authorised repairer or ASC.
8. This warranty, the contract to which it relates and the relationship between you and Electrolux are governed by the law applicable where the Appliance was purchased. Where the Appliance was purchased in New Zealand for commercial purposes the Consumer Guarantee Act does not apply.
9. To the extent permitted by law and subject to your non excludable statutory rights and warranties, Electrolux excludes all warranties and liabilities (other than as contained in this document) including liability for any loss or damage whether direct or indirect arising from your purchase, use or non use of the Appliance.
10. For Appliances and services provided by Electrolux in Australia, the Appliances come with a guarantee by Electrolux that cannot be excluded under the ACL. You are entitled to a replacement or refund for a major failure and for compensation for any other reasonably foreseeable loss or damage. You are also entitled to have the Appliance repaired or replaced if the Appliance fails to be of acceptable quality and the failure does not amount to a major failure. The benefits to you given by this warranty are in addition to your other rights and remedies under a law in relation to the Appliances or services to which the warranty relates.
11. At all times during the Warranty Period, Electrolux shall, at its discretion, determine whether repair, replacement or refund will apply if an Appliance has a valid warranty claim applicable to it.
12. For Appliances and services provided by Electrolux in New Zealand, the Appliances come with a guarantee by Electrolux pursuant to the provisions of the Consumer Guarantees Act, the Sale of Goods Act and the Fair Trading Act.
13. To enquire about claiming under this warranty, please follow these steps:
  - (a) carefully check the operating instructions, user manual and the terms of this warranty;
  - (b) have the model and serial number of the Appliance available;
  - (c) have the proof of purchase (e.g. an invoice) available;
  - (d) telephone the numbers shown below.
14. You accept that if you make a warranty claim, Electrolux and its ASC may exchange information in relation to you to enable Electrolux to meet its obligations under this warranty.

## Important Notice

Before calling for service, please ensure that the steps listed in clause 13 above have been followed.

<p><b>FOR SERVICE</b> or to find the address of your nearest state service centre in Australia <b>PLEASE CALL 13 13 49</b> <small>For the cost of a local call (Australia only)</small></p>	<p><b>SERVICE AUSTRALIA</b>  <b>Electrolux</b> ELECTROLUX HOME PRODUCTS www.electrolux.com.au</p>	<p><b>FOR SPARE PARTS</b> or to find the address of your nearest state spare parts centre in Australia <b>PLEASE CALL 13 13 50</b> <small>For the cost of a local call (Australia only)</small></p>
<p><b>FOR SERVICE</b> or to find the address of your nearest authorised service centre in New Zealand <b>FREE CALL 0800 10 66 10</b> <small>(New Zealand only)</small></p>	<p><b>SERVICE NEW ZEALAND</b>  <b>Electrolux</b> ELECTROLUX (NZ) Limited www.electrolux.co.nz</p>	<p><b>FOR SPARE PARTS</b> or to find the address of your nearest state spare parts centre in New Zealand <b>FREE CALL 0800 10 66 20</b> <small>(New Zealand only)</small></p>



# Westinghouse

## Key Feature Guide

### **Sensordry System**

moisture sensing to protect your clothes from overdrying

### **A big door**

32cm wide opening window door for easy loading and viewing

### **Wall mounting kit**

easy install with the included wall mounting brackets

### **Front lint filter**

for easy access and to encourage safe and economical operation

### **Front venting**

easy venting of moist exhaust air away from your laundry walls

### **Optional rear venting**

with our vent tube kit you can exhaust out of your laundry

### **Economical operation\***

dry a 5kg load for 50c

### **Faster drying**

dry 6kg in the time that 4.5kg dry on others

### **Improved safety**

the heater element is now located away from the drum

\*Based on 11.6c/kWh - check with your local energy supplier for your local rate

Product .....Date of Purchase .....  
Model .....Serial Number .....  
Purchaser's Name .....  
Full Postal Address .....  
.....  
Retailer (Shop) .....  
Address .....

*Please keep this book and your Proof of Date of Purchase to show the technician if you need service during the warranty period.*



**From the Electrolux Group.**  
KITCHEN, CLEANING AND OUTDOOR APPLIANCES

