



Assembly and Operating Instructions

DISCOVERY 1100 SERIES TRIM KIT

1100S, 1100E, 1100

3, 4 OR 5 BUILT IN BURNERS

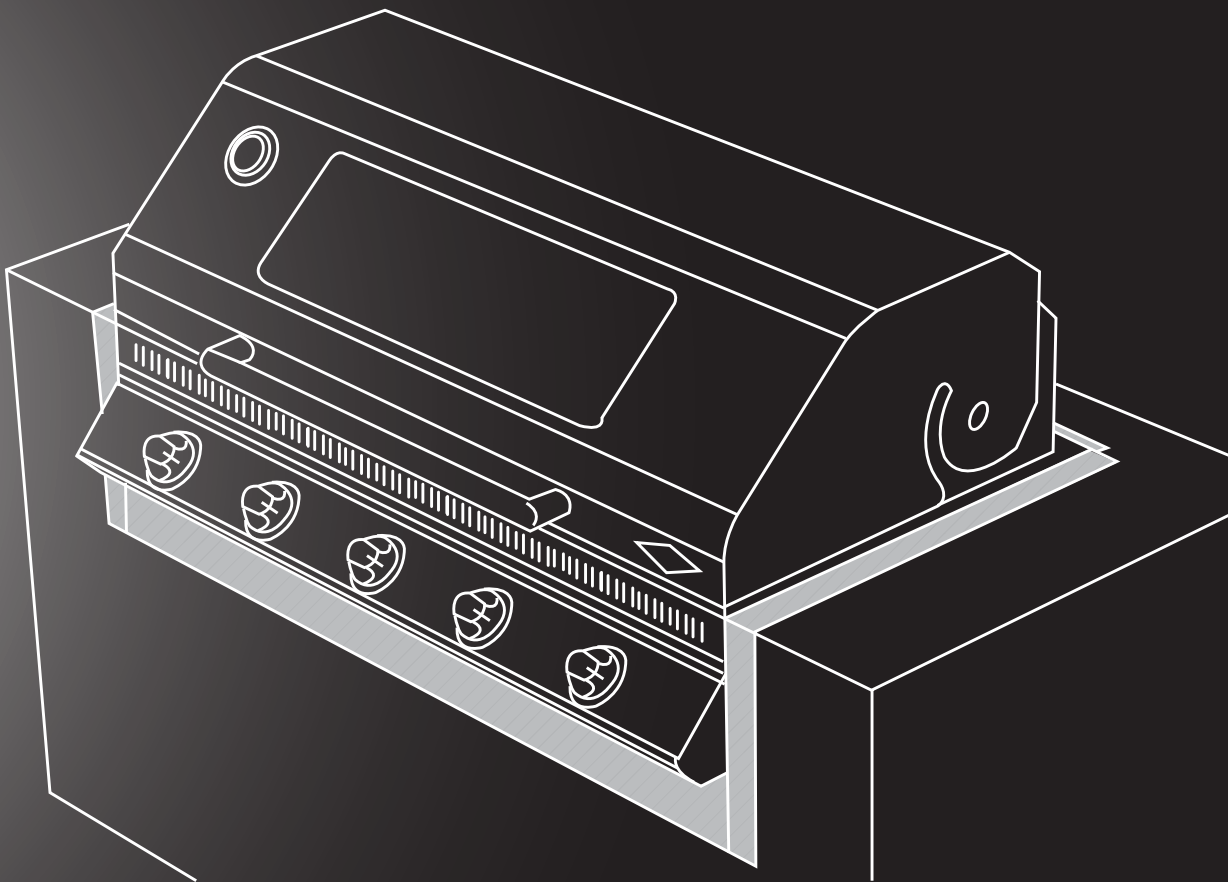

Contents

QTY	DESCRIPTION	QTY	DESCRIPTION
1	Front Cover	10	M6 x 12mm Screws
1+1	RH Bracket + LH Bracket	10	M6 Fiber Washers
1	Back Cover		

Instructions

NOTE: the full Barbecue assembly instructions can be found in the Barbecue Carton. These instructions only refer to placement of Trims in Built-In situations.

- 1) Attach the RH Bracket and LH Bracket to Barbecue body using 8 off M6 x 12mm screws as follows:

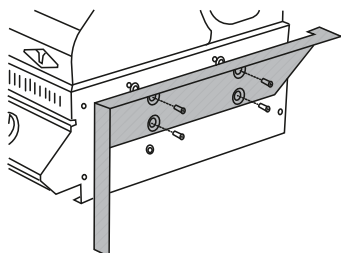

NOTE: Washers are to be placed between the Barbecue body and the bracket.

- 2) Place BBQ into its position in the bench, resting on the brackets installed in (1).
- 3) Attach the rear trim to place:

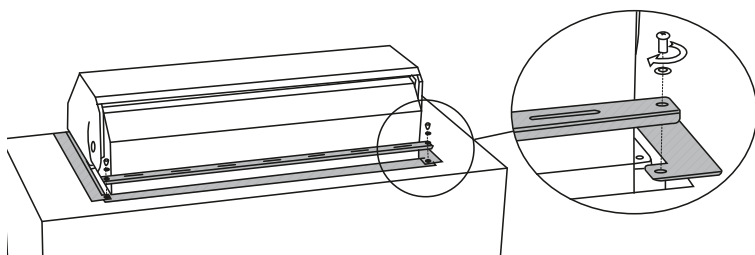

- 4) The front cover can be removed for accessing the Fat-Collecting Pan and replaced:

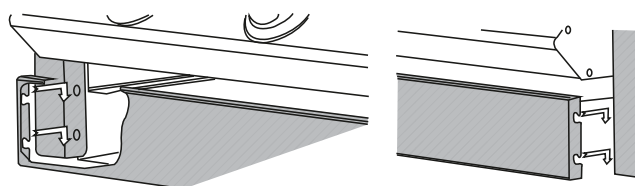

AUSTRALIA

phone: 1300 307 939
 fax: 1800 356 669
 email: customercare@electrolux.com.au
 web: beefeaterbbq.com

NEW ZEALAND

phone: 0800 436 245
 fax: 0800 225 088
 email: customercare@electrolux.co.nz
 web: beefeaterbbq.com